

Close limit

1. Hold the **SET + CLOSE** buttons at the same time for 3 seconds. The motor will move to indicate the process has started.

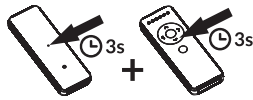

2. Use **OPEN** and **CLOSE** buttons to go to the desired closed position.

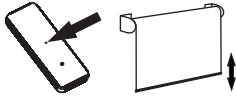

3. Press **SET** button on the back of the remote control. The motor will move to indicate that the close limit has been saved.

Setting favorite positions

Favorite position 1

1. Use **OPEN, STOP** and **CLOSE** buttons to go to the desired favorite position 1.

2. Press the **SET + FAVORITE 1** buttons at the same time. The motor will move to confirm that the favorite position 1 was saved.



Favorite position 2

1. Use **OPEN, STOP** and **CLOSE** buttons to go to the desired favorite position 2.

2. Press the **SET + FAVORITE 2** buttons at the same time. The motor will move to confirm that the favorite position 2 was saved.



Reverse direction

1. Hold the **SET** button on the back of the remote control for 3 seconds. The motor will move up and down to indicate the process has started.

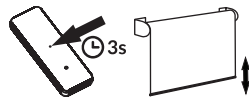

2. Press the **CHANNEL* + STOP** buttons at the same time, the motor will move up and down to confirm the operation.



***RC215, RC230:** Press the **PREVIOUS CHANNEL + STOP** buttons at the same time.

Delete limits

1. Hold the **SET + STOP** buttons at the same for 3 seconds. The motor will move to indicate the limits have been deleted.



Delete all remote controls

Note: this procedure does not delete open and close limits or the favorite positions 1 and 2.

1. Hold the **HEAD** button for 3 seconds, until the motor moves, then release it.

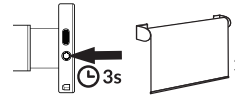

2. Hold the **HEAD** button for 7 seconds, until the motor moves.

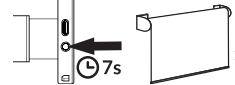

Troubleshooting

Motor is not responding

No power: Make sure you have correctly connected the DC 24V power adapter.

Not holding the HEAD button long enough: To enter pairing mode, you need to press the button, and keep it pressed, for 3 seconds, until the motor moves.

Cannot pair with remote control

The motor pairing mode lasts 30 seconds. Pressing the set button on the back of the remote control should be done within this period. Make sure you are using the right remote control and it has a battery. If there are too many 433MHz RF devices transmitting in the environment (RF noise), it may interfere with the pairing process.

Motor only moves inch by inch in one or both directions

This behavior means that the open and/or close limits have not been set. Refer to the setting limits section. For other remote control models, please consult our website (neosmartblinds.com/motors-accessories/).

For further information, please consult help.neosmartblinds.com/portal/

Motor specifications

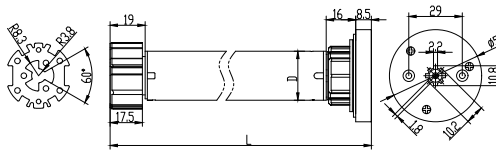

see L and D below
All dimensions are in millimeters

TM-RT25 supports external Blue Link through the Blue Link port
TM- WRT25 internal Wi-Fi

Description: 25.6 mm diameter (D), 283.5 mm in length (L), RF 433.92 MHz, external antenna, DC 24V 450mA, 1.5 Nm, 30 rpm, 5.5mm DC Jack.

Disposal

Do not dispose of motors or their parts with your regular waste. Please recycle damaged electronic products according to local regulations.

NEO SMART BLINDS

NEO TRANSFORMER

TUBULAR MOTOR

Works with all Neo Remote Controls

Version 1.0

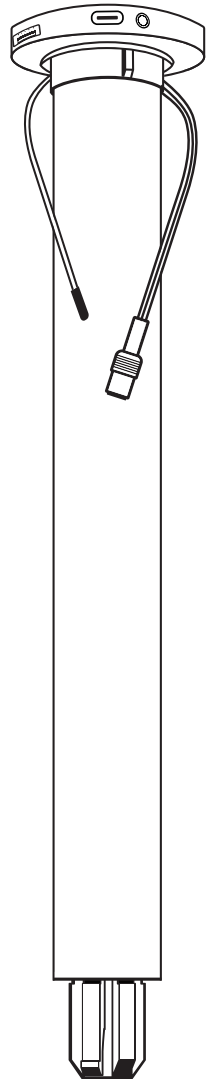

ENGLISH

Models

TM-RT25

TM-WRT25

Getting to know your Neo Transformer Tubular Motor

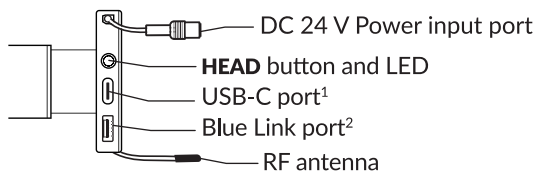

- 1 - No function
2 - TM-RT25 motors only. Supports external Blue Link through the Blue Link port

Power Connection.

Wires Polarity



Solid white: negative (-)
Dashed lines: positive (+)

Caution

- Motor must be installed in a horizontal position and used with correct crown and drive adapters for tubular blinds.
- Keep remote controls, Smart Controller, Blue Link and apps away from children.
- Ensure all cables and connected devices are protected and clear from moving parts.
- An environment with multiple 433MHz devices may interfere with the normal usage of the motor.
- Misuse or any design modification will void warranty.

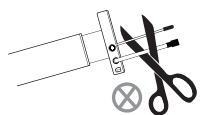

DO NOT CUT ANY CABLES OR THE ANTENNA

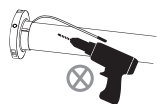

DO NOT DRILL OR CUT ANY PART OF THE MOTOR

Scan the QR code to access the Remote Control instructions page on our website, or visit:
neosmartblinds.com/motors-accessories/



Neo Remote Control Models RC201, RC202, RC206

For other remote control models, please refer to the instructions inside the box of the remote control.

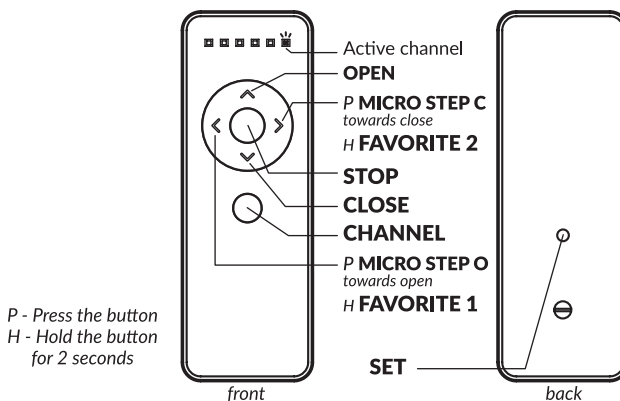

P - Press the button
H - Hold the button for 2 seconds

For a remote control to execute commands on a motor, its active channel must be paired with that motor. Refer to the "Pairing Process" section for instructions.

Basic operation

Key	Description
Hold HEAD for 3 seconds	The motor enters and stays in pairing mode for 30 seconds
Press HEAD once	If the motor is in pairing mode, it exits the mode
Hold HEAD for 3 seconds, release it, then hold it for 7 seconds	The motor enters pairing mode; then, it deletes all remote control channels registered in memory.
Press OPEN	The motor moves all the way to the open limit.
Press CLOSE	The motor moves all the way to the close limit.
Press STOP	The motor stops any ongoing motion.
Press MICRO STEP O	The motor moves a small amount towards the open limit.
Press MICRO STEP C	The motor moves a small amount towards the close limit.
Hold FAVORITE 1 for 2 seconds	The motor moves to the favorite position 1.
Hold FAVORITE 2 for 2 seconds	The motor moves to the favorite position 2.
Press CHANNEL	The remote control cycles to the next channel (or group of channels), making it active¹.

1 - This command is not sent to the motor, and affects only the remote control on which it is executed.

Pairing process

Up to 16 channels can be stored on the motor.

Using a Neo Remote Control

1. Using the remote control, press the **CHANNEL** button as many times needed to **select the desired channel** to pair the motor.

RC215, RC230: Press the **PREVIOUS CHANNEL** or the **NEXT CHANNEL** buttons.

2. Hold the **HEAD** button for 3 seconds, until the motor moves.

3. Press the **SET** button on the back of the remote control, the motor will move to confirm the operation.

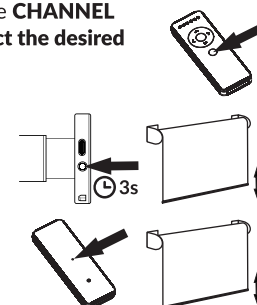

Using the mobile apps

Neo Smart Blinds



Download the app to your mobile device by searching for **Neo Smart Blinds** on Google Play or App Store. You will need to create an account and **add a Smart Controller before pairing blinds** to the app.

TM-RT25: Compatible with all Smart Controller models.

TM-RT25 with Blue Link: Only the C-BR300 model can show battery level and the blind's current position.

TM-WRT25: Smart Controller is not required.

Neo Smart Blinds Blue



Download the app to your mobile device by searching for **Neo Smart Blinds Blue** on Google Play or App Store. It supports **TM-RT25 with Blue Link** motors.

Setting limits

If the motor comes with no limits set from the factory, the open and close commands will be the same as micro step o and micro step c.

Open limit

1. Hold the **SET + OPEN** buttons at the same time for 3 seconds. The motor will move to indicate the process has started.

2. Use **OPEN** and **CLOSE** buttons to go to the desired opened position.

3. Press **SET** button on the back of the remote control. The motor will move to confirm that the open limit has been saved.

